

THREADED PROBES



F727

5 A | 100 mil | Threaded

Electrical specifications

Temperature [°C]	-45°...+100°	
Current [A]	5	
R _{TYP} [mOhm]	<25	

Mechanical specifications

Preload [cN]	50	110
Spring force [cN] at nt ±20%	150	300
Nominal travel [mm]	12.0	12.0
Maximum travel [mm]	14.5	14.5

Materials and plating

Plunger	BeCu	gold plated
Barrel	Brass	gold plated
Spring	Spring steel	silver plated
Receptacle	Brass	gold plated

Accessories

1015757	H727LA	Receptacle
1014264	FEWZ-100E0	Insertion tool receptacle
1004610	FWZ732T	Screw-in tool probe $\lt; \varnothing 2.0 \text{ mm}$

Drill size recommendation (mm)

1015757	H727LA	2.00 - 2.02
---------	--------	-------------

Series drawing

All measurements are in mm.

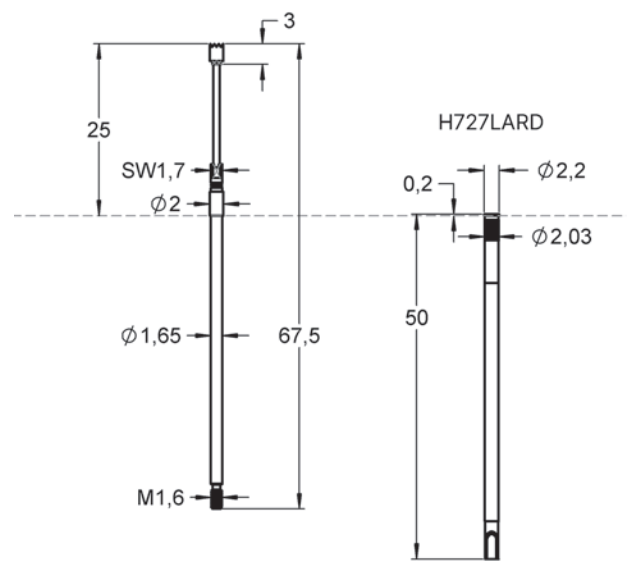

Order code	Product name	Tip Style	Tip \varnothing [mm]	Material/Plating	Force [cN]	Thread [M]	Version	FM Choice
1027514	F72706B200G150	06 	2.00	B / G	150	M1.6	-	-
1015738	F72706B200G300	06 	2.00	B / G	300	M1.6	-	-
1021907	F72712B140G300	12 	1.40	B / G	300	M1.6	-	-
1018329	F72715B200G300	15 	2.00	B / G	300	M1.6	-	-