

SWITCH PROBES

FM Choice **NEW**

F898 (NO)

Off-On-Off | 244 mil | Pneumatic



Electrical specifications

Temperature [°C]	-45°...+100°
Current [A]	3
Current switch [A]	1
R _{TYP} [mOhm]	<100

Mechanical specifications

	Working travel [mm]	Contact force at 6 bar [cN]
Switch Point 1	3.5	±0,3
Nominal travel [mm]	3.7	450 ±20%
Switch Point 2	4.5	±0,2
Maximum travel [mm]	4.8	
Operating pressure	5-7 bar	Change 130cN/bar
Operating medium	Compressed air (dried & filtered)	
Allowed leakage rate	5 cm ³ /min.	

Materials and plating

Plunger	Synthetic	unplated
Barrel	Brass	gold plated
Spring	Spring steel	silver plated

Accessories

1021542	2104456	Connecting plug
1002634	2100782 (NW2)	Pneumatic tube

Order code	Product name	Tip Style	Tip Ø [mm]	Material/Plating	Force [cN]	Thread [M]	Version	FM Choice
1142368	F89817K250U450	17	2.50	K / U	450	-	-	

Application and Mounting

Special solution for a pneumatic presence test at limited space. An integrated switch function allows to detect the exact position of the test item. For an adjustable position of the F898 in axial direction a lateral setscrew (M2, max. torque 8 cNm) can be used. For a fix and secure position the F898 can be mounted by an axial setscrew (M8).

Series drawing

All measurements are in mm.

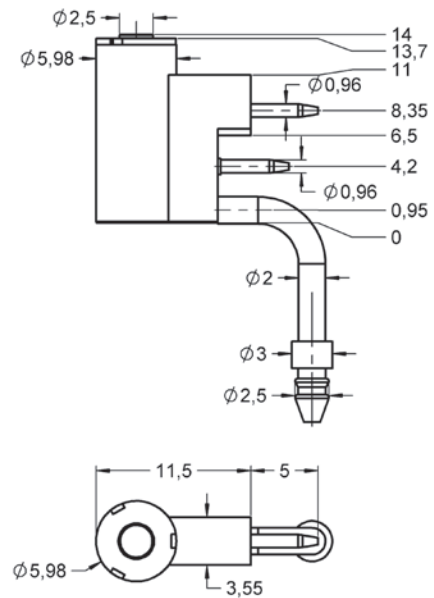

Switch-Characteristic

