

LINEAR ARM FIXTURE

LHS²

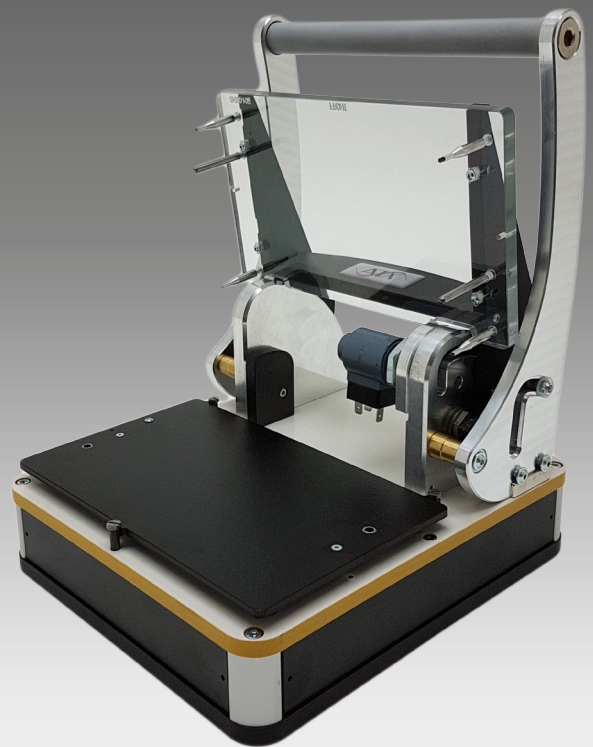

SPECIALIST FIXTURE SOLUTIONS

MECHANICAL FIXTURES

LHS² – linear arm fixtures

HIGHLIGHTS

- Ideal for high-precision tasks
- Individually adaptable
- Effortless operation
- For two-sided operation
- Available in 5 sizes

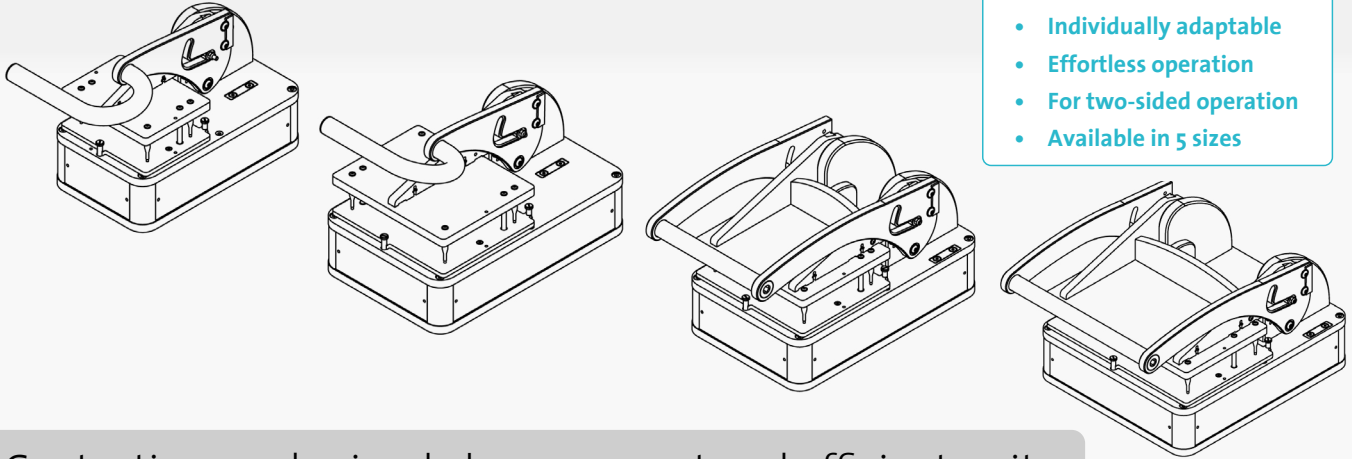

Contacting made simple by a compact and efficient unit

Regardless of whether your company's inspection and testing work deals with experimental series, localised and limited analyses or even laboratory operations: whether you wish to implement the requirements of your programming test stations even more efficiently with a mechanical fixture; or whether you wish to equip your functional test stations innovatively for future tasks and open up new dimensions for your function tests. In the LHS² linear arm fixture from ATX you have the ideal unit for all these purposes, with a wide range of impressive features. Our LHS² is even suited for flash programming tasks, if this is an option you need. And if your specific application requires this, the unit also offers two-sided operation.

The LHS² from ATX is not only small, extremely compact and totally uncomplicated in its operation – it also enables you to master all your testing operations quickly and economically. And because you will be adding a „Made in Germany“ mechanical fixture to your testing environment, you can be sure of premium quality, outstanding technical features and a long product life.

But that's not all. Because our linear arm fixture represents an entry to mechanical inspection and testing which has been tried and tested over many years, we can offer you optimum technical capacity for comparatively little money.

- Available ex-stock as a standard kit at any time, if you wish to extend the unit yourself,
- Or as an individually designed special model which is made to measure for your specific requirements.

Simply let us know what your test-specific wishes are and we will design a tailor-made solution which will also offer you the full range of modification and adaptation options later, too.

The high-capacity LHS² from ATX is available in four sizes. It represents precise results because it supports your testing experts with linear lift. In application the lever is lowered vertically onto the test probes, avoiding any bending of the probes and providing you with reliable test results.

In 5 compact standard sizes*

Order number	Designation	Moving plate	Contact pressure
100707	LHS ² -A	85 x 85	100N
100331	LHS ² -B	125 x 125	100N
100828	LHS ² -D	125 x 125	200N
100333	LHS ² -E	350x 150	200N
100361	LHS ² -F	200 x 130	200N
100329	LHS ² WG-F	200 x 130	200N
100330	LHS ² WK-F	200 x 130	200N

Standard sizes with inner height 80mm

Order number	Designation	Moving plate	Contact pressure
100241	LHS ² -A-High	85 x 85	100N
100242	LHS ² -B-High	125 x 125	100N
100342	LHS ² -E-High	350 x 130	200N
100341	LHS ² -F-High	200 x 130	200N

Pneumatic locking LHS²

Order number	Designation
100335	LHS ² pneumatic locking with lift magnet
100334	LHS ² pneumatic locking with cylinder

* Each supplied with 20 30 mm pushfingers, 4 35 mm holding-down devices and 20 UUT supports.

AVAILABLE HOUSING OPTIONS

If required we adapt the technical design exactly to your requirements

Housing with back panel (connectors can be fitted as required)

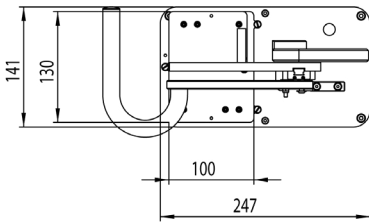

100707

Standard housing for LHS²-A

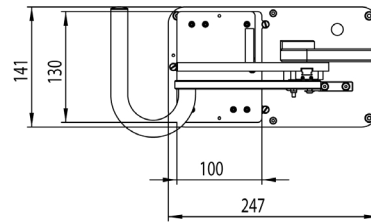
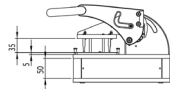

100241

Standard housing for LHS²-A-High

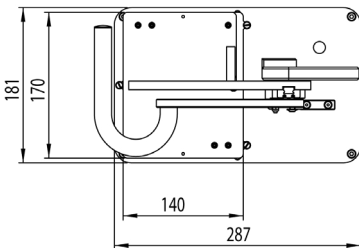
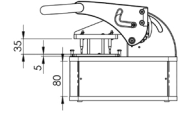

100331

Standard housing for LHS²-B

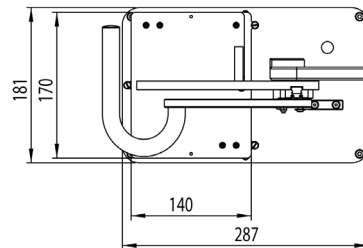
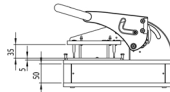

100242

Standard housing for LHS²-B-High

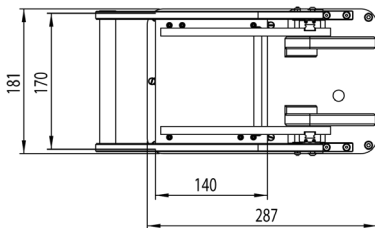
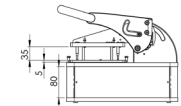

100828

Standard housing for LHS²-D

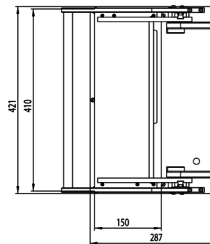
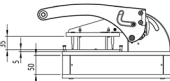

100333

Standard housing for LHS²-E

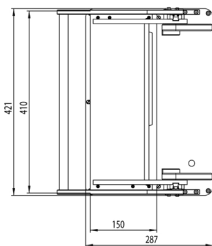
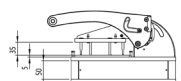

100342

Standard housing for LHS²-E-High

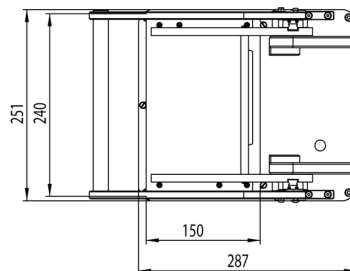
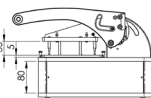

100961

Standard housing for LHS²-F

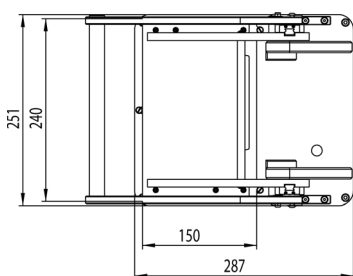
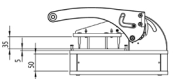

100341

Standard housing for LHS²-F-High

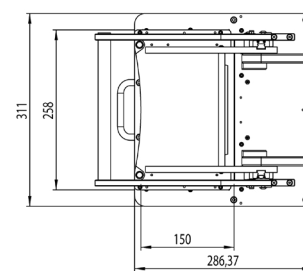
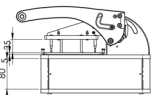

100329

Standard housing for LHS²WG-F

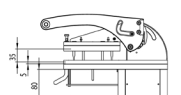

Contact us



Would you like to find out more about us or get in touch with the appropriate contact person?
You'll find the direct line on our website - together with your personal sales expert:

www.atx-hardware.de ► [Contact](#)

We are committed to finding the optimal technical solution for you. Why not put us to the test!

ATX Hardware GmbH West
Subsidiary of ATX Hardware GmbH

 **Cotelec**

Composants & Technologies pour l'Electronique

 **Cotelec**
Composants & Technologies pour l'Electronique

Simon BARRY
Technico-commercial

E-mail : simon.barry@cotelec.fr
Tél. : 01 69 28 05 06
Fax : 01 69 28 63 96

1, rue de Terre-Neuve - Bâtiment H - BP 90144
91944 - Les Ulis / Courtabœuf cedex
France

www.cotelec.fr