



LHS2
LINEAR ARM FIXTURE

TABLE OF CONTENTS

3	Specialist fixture solutions
3	Fixture assembly
4	Innovative level mechanism
5	Mechanical standalone fixture
6	Stand-Alone and Exchange System
7	Available housing types

Imprint

Publisher:

ATX Hardware GmbH West

Am Kornfeld 8

86932 Pürgen

Germany

Phone +49 8196 9304-0

Telefax + 49 8196 9304-19

E-Mail: projekte@atx-hardware.de

Website: www.atx-hardware.de

SPECIALIST FIXTURE SOLUTIONS

ATX is Europe's market leader in the manufacture of test fixtures for electronic test procedures.

Why you too should choose an ATX fixture - it's simple:

TECHNICAL KNOW-HOW

Our sales team is technically well versed - our consultants are selected from the design team or other technical departments.

PROJECT KNOW-HOW

We work together with you towards a common goal: to find and implement the optimal solution for your individual testing requirements.

KNOWLEDGE BASE

Our employees bring well over 1,000 man-years of fixture building experience to the team.

SINCE 1997

FIXTURE ASSEMBLY

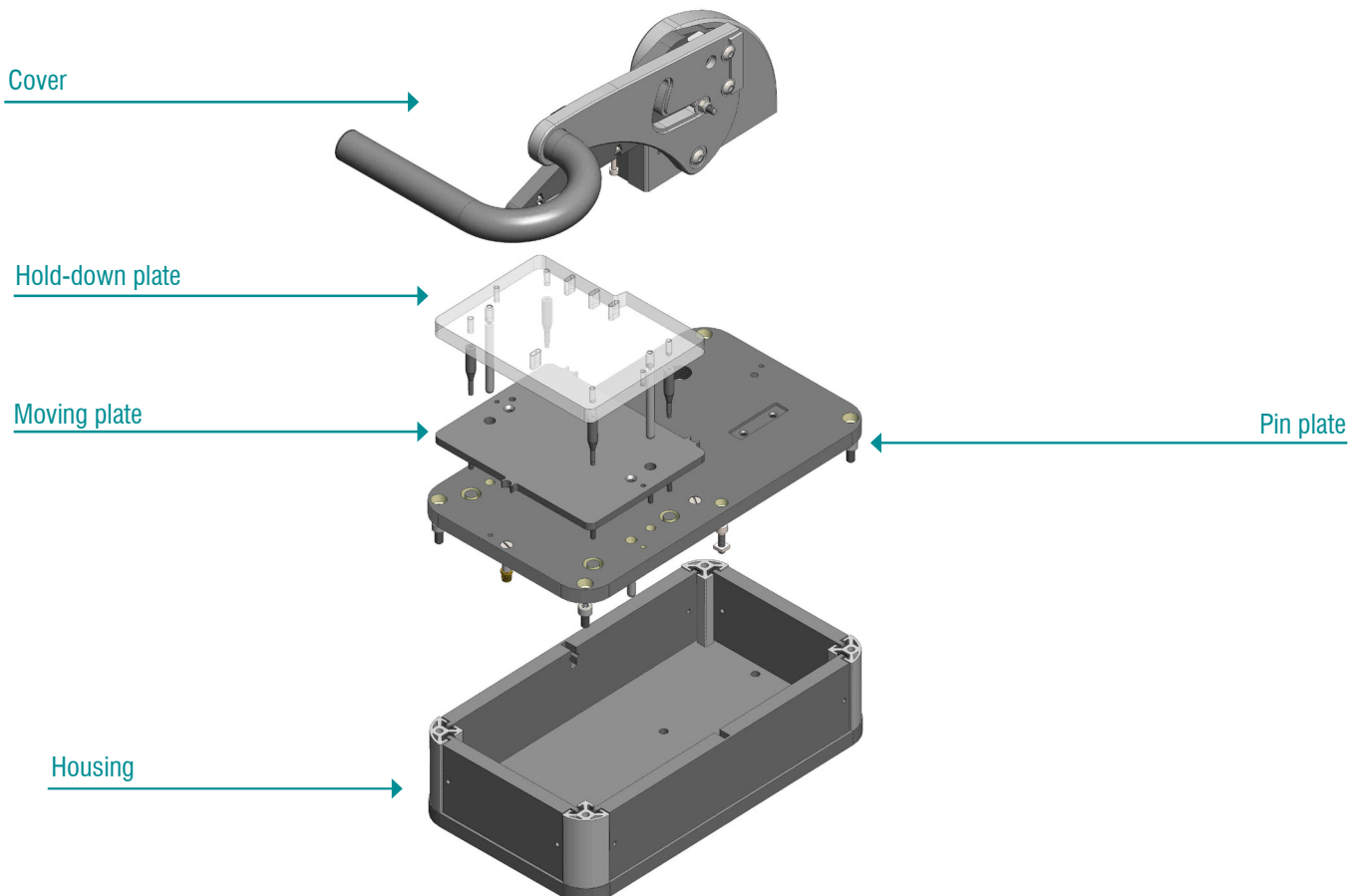

INNOVATIVE LEVER MECHANISM



HIGHLIGHTS

- Ideal for selective indications
- Individually customizable
- Effortless operation
- For adaption on both sides
- In 5 versions

RADIAL AND LINEAR STROKE - THE LINEAR ARM FIXTURE.

The special feature of our LHS² is not only the compact, efficient and cost-effective variant in fixture construction, but also quite clearly the radial and simultaneously linear stroke. This also explains the name for our **linear arm fixtures**. With this design, the placed hold-downs are pressed evenly linearly onto the assembly with the arm transmission and thus contact the needles. The main advantage here is that the spring contact pins are pressed absolutely vertically and precisely. The centering of the hold-down plate also offers an optimized hold-down option, even for tightly assembled assemblies. The generous opening angle enables uncomplicated handling during insertion and removal.

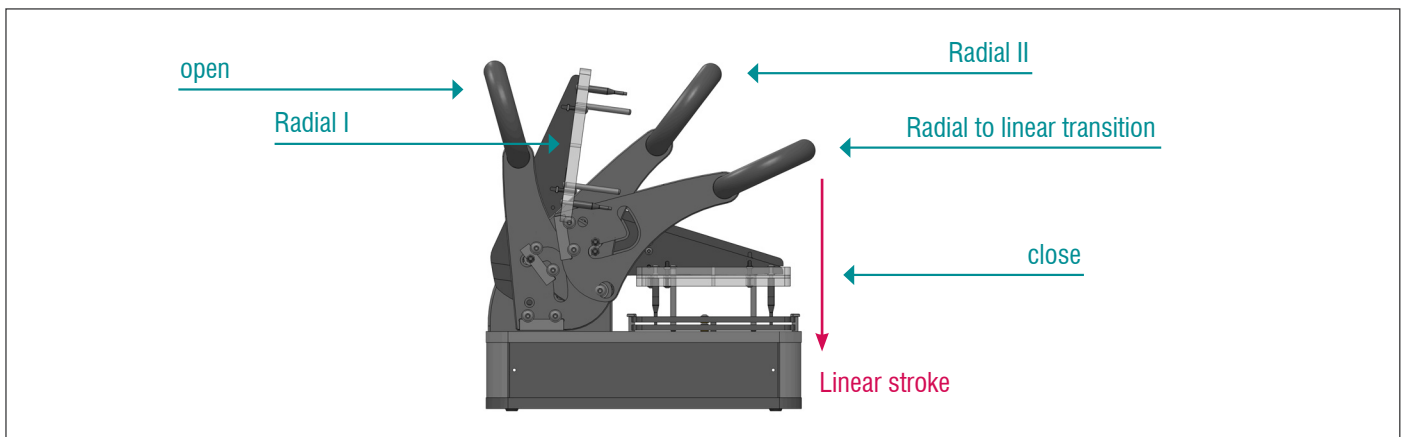

FIXTURE-CONFIGURATOR

CONFIGURE YOUR INDIVIDUAL TEST FIXTURE

LHS²-Series

Our fixture configurator was developed especially for you. Together with our sales specialists and designers, it is constantly adapted and further developed. Configure your individual test fixture now, which is specially adapted to your needs, on our homepage and receive your exclusive offer.

► **Go to the configurator** (https://www.abx-hardware.de/en/product-category/mechanical_fixtures/linear-lever-clamp/)

MECHANICAL STANDALONE FIXTURE

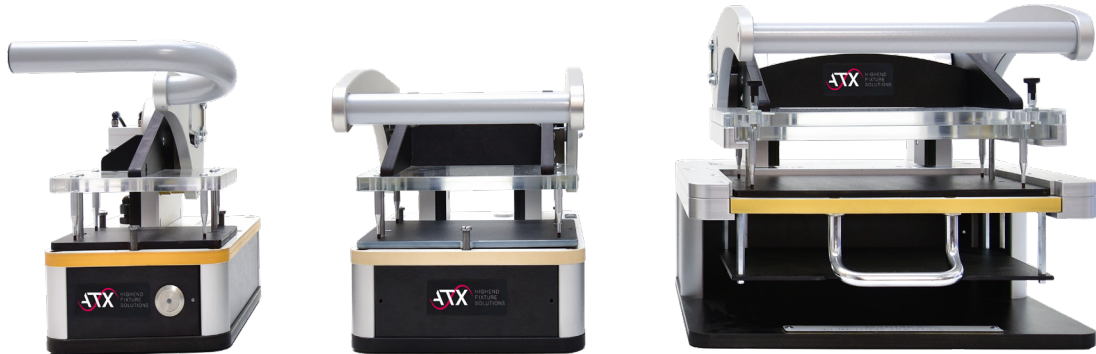

SIMPLY CONTACT MORE EFFICIENTLY WITH OUR LHS²-SERIES.

If your company's testing and checking involves small series, programming or laboratory tasks, you can solve these even more efficiently with the LHS2. Also if you want to equip your functional test stations innovatively for future tasks and open up new dimensions for your functional tests. With the LHS² linear lever adapter from ATX, you have the perfectly suitable device with many convincing advantages.

And if required for your specific application, it also works on both sides. The LHS² from ATX is not only small, extra compact and absolutely uncomplicated to operate. It also helps you to handle upcoming inspection tasks quickly and economically. And because you are getting a mechanical lever device „Made in Germany“ in your test environment, you are assured of the highest quality, outstanding product substance and long service life.

But that's not all: Since our linear lever adapter represents the proven entry-level class in mechanical inspection and testing that has been technically tested over many years, we can provide you with a maximum technical and economic solution.

- Anytime from stock as standard kit, if you want to dismantle your device yourself
- Or as a completely customized ready-to-use adapter - exclusively adapted to your specific requirements

STANDALONE FIXTURE LEGEND

Mechanical standalone fixture

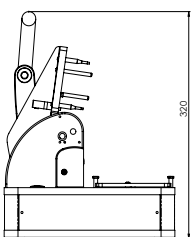

LHS²-Standard height 50mm

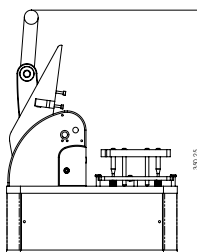
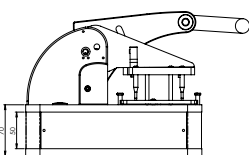



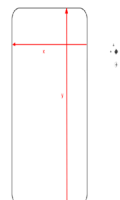
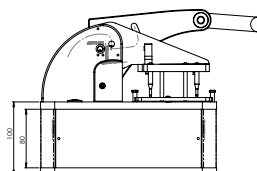

LHS²-Special height 80mm





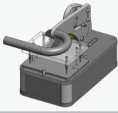

Moving plate dimension X x Y

LHS²-SERIES | STAND-ALONE AND EXCHANGE SYSTEM

STANDARD - IN 5 COMPACT SIZES

Designation	Fixture	Board size (X x Y)	Pressure force	Order number
LHS ² -A		85 x 85	100 N	100707
LHS ² -B		125 x 125	100 N	100331
LHS ² -D		125 x 125	200 N	100828
LHS ² -E		350 x 130	200 N	100333
LHS ² -F		200 x 130	200 N	100961

STANDARD - WITH SPECIAL HEIGHT 80MM

Designation	Fixture	Board size (X x Y)	Pressure force	Order number
LHS ² -A-High		85 x 85	100 N	100241
LHS ² -B-High		125 x 125	100 N	100242
LHS ² -D-High		125 x 125	200 N	100338
LHS ² -E-High		350 x 130	200 N	100342
LHS ² -F-High		200 x 130	200 N	100341

INTERCHANGEABLE SYSTEM | BASIC UNIT AND INTERCHANGEABLE CASSETTE

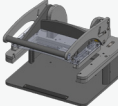
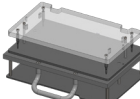
Designation	Fixture	Board size (X x Y)	Pressure force	Order number
LHS ² -WG-F		200 x 130	200 N	100329
LHS ² WK-F		200 x 130	200 N	100330

AVAILABLE HOUSING VARIANTS

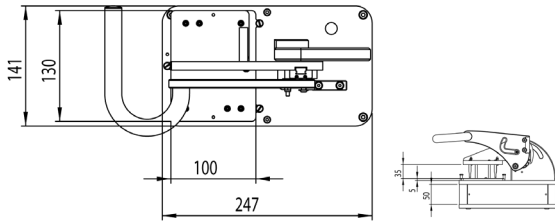

100707

Standard housing for LHS²-A

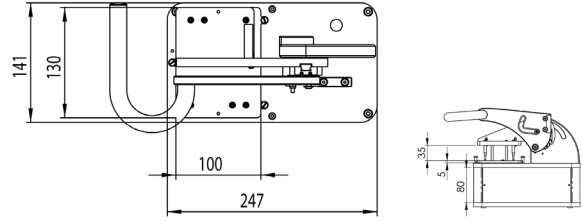

100241

Standard housing for LHS²-A-High

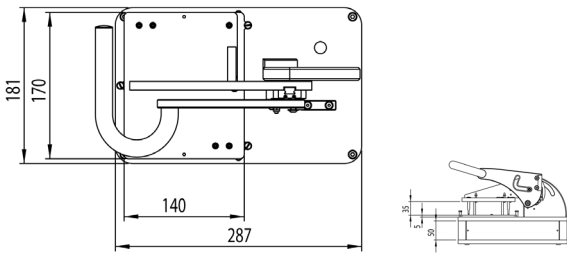

100331

Standard housing for LHS²-B

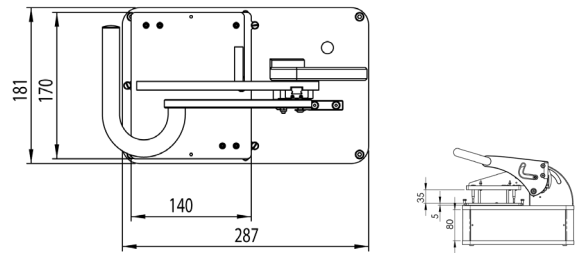

100242

Standard housing for LHS²-B-High

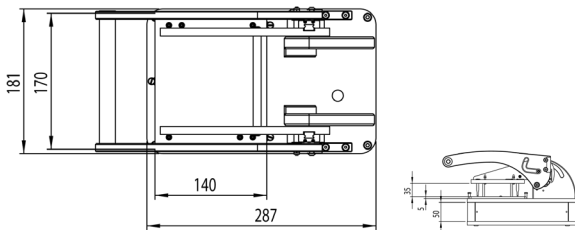

100828

Standard housing for LHS²-D

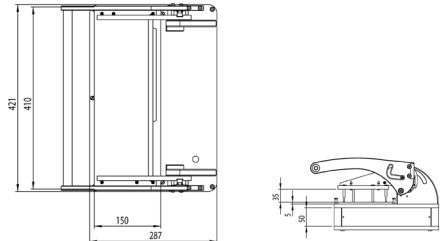

100333

Standard housing for LHS²-E

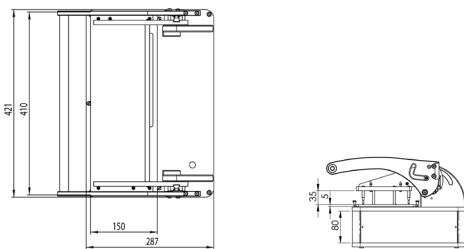

100342

Standard housing for LHS²-E-High

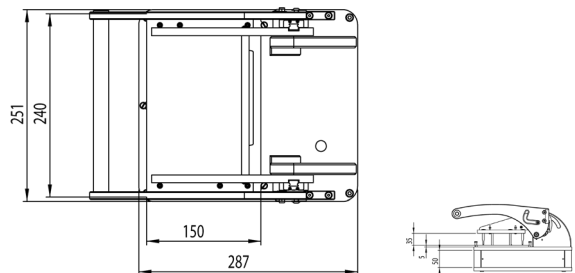

100961

Standard housing for LHS²-F

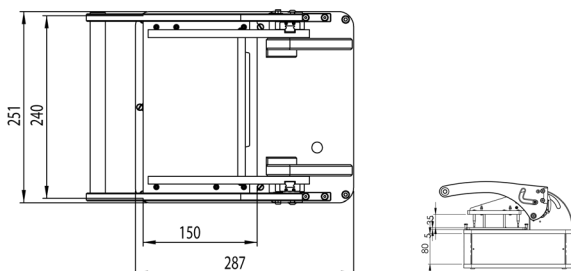

100341

Standard housing for LHS²-F-High

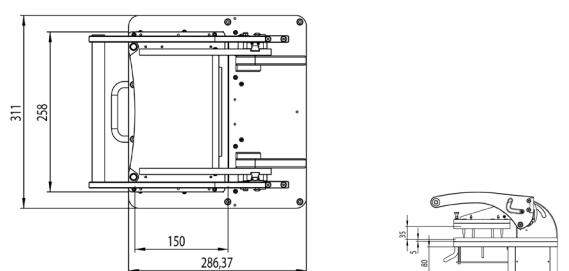

100329

Standard housing for LHS²WG-F



ATX HARDWARE GMBH WEST

Location Pürgen

Am Kornfeld 8
86932 Pürgen
Germany
P +49 8196 9304-0
F +49 8196 9304-19
projekte@atx-hardware.de

Location Weil im Schönbuch

Carl-Zeiss-Straße 5/1
71093 Weil im Schönbuch
Germany
P +49 8196 9304-536
F +49 8196 9304-359
projekte@atx-hardware.de